

Fitting Procedure

Once the hardware is mounted, install the VPS guards (11) to the backbones thanks to the 2x 10mm Mush Philips Head screw (12) provided.
The extra wind deflectors (13) can be installed (if desired) on the VPS guards in 2 positions (low and high) thanks to the 2x 13.5mm screws (14) provided.

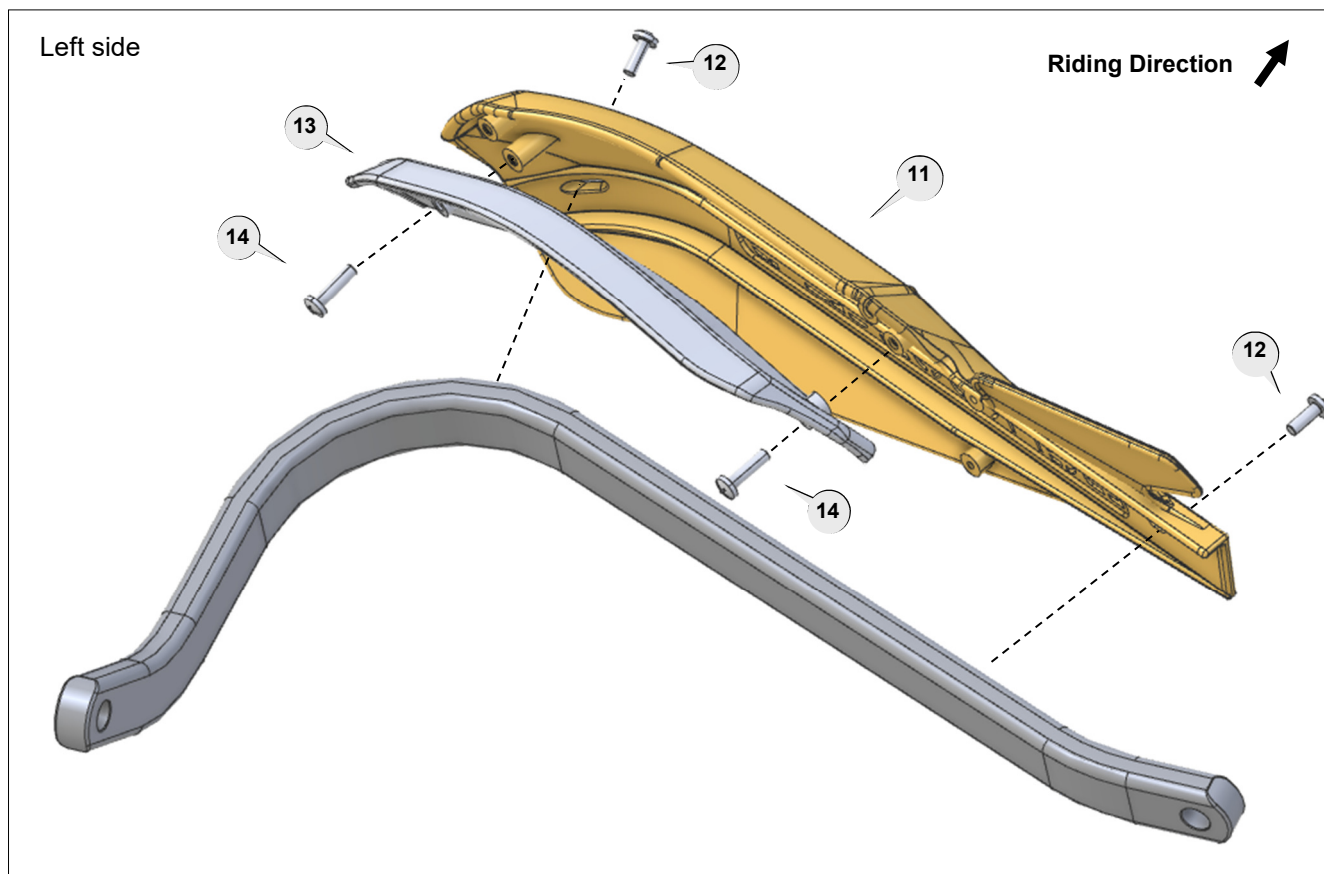

1 Aluminium Bar  PN: BAR-V-060 Pcs. 1 Left & 1 Right	2 Clamp Saddle  PN: CS-03 Pcs. 2 Pairs	3 Clamp Connector  PN: CP5 Pcs. 2	4 Socket Head Bolt 25mm  PN: M6x25SHCSZP Pcs. 2	5 Socket Head Bolt 30mm  PN: M6x30SHCSZP Pcs. 2	6 Nylock Nut  PN: M6LN Pcs. 4	7 Button Head Bolt 25mm  PN: M8x25BHCSZP Pcs. 2	8 Flat Head Bolt 50mm  PN: M10x50BHCSZP Pcs. 2
9 Bar End Weight  PN: BEW-35-10 Pcs. 2	10 Spacer  PN: SP07-20-10 Pcs. 2	11 Plastic Guards  PN: BVPS-BK Pcs. 2 (L/R)	12 Self Tapping Screw  PN: STSZ811MX11 Pcs. 4	13 Wind Deflector  PN: BVPS-WD-BK Pcs. 1 Left & 1 Right	14 Wind Deflector Screw  PN: SCREWPT3.5x14 Pcs. 4		

Recommended Torque Settings	
M6	10 Nm (7.4 lbf ft)
M8	28 Nm (20.7 lbf ft)
M10	32 Nm (23.6 lbf ft)
M16 (item 9)	21Nm (15.5 lbf ft)

CAUTION:

Installation of the handguard is safety-relevant work and can be complicated. We recommend the installation be performed by a motorcycle service technician. Rideworx accepts no liability for damages caused by improper mounting. All screws, bolts and nuts, including all replacement hardware provided by Rideworx, should be tightened to the torque specified in the below table. After the first 50km of riding check all screws, bolts and nuts are tightened to the correct torque. We recommend a medium strength liquid thread lock product on all fasteners.

WARNING:

It is important there is a working clearance (approx 3mm) between the throttle grip end and the handguard to ensure a free closing throttle. Check operation of all handlebar controls, specifically the throttle, front brake, kill switch and clutch to ensure they are operating correctly and are in accordance with the OEM specifications. Do not ride the motorcycle if any controls are not operating correctly. Check periodically that all bolts are tight.



RIDEWORX

Phone: +61 (0)2 4271 8244
 Email: info@barkbusters.net
 Web: www.barkbusters.net



Disclaimer:

A failure to follow these fitting instructions could cause serious injury, death or property damage. These handguards are intended solely for use with motorcycles/ATV/snowmobiles/scooters that have not been modified. They are not designed to prevent injury or death while riding or in an accident or crash. The user must ensure that all controls are free of the handguards every time that they ride. By installing and/or using this product you acknowledge that you accept these terms and have followed the fitting instructions.