

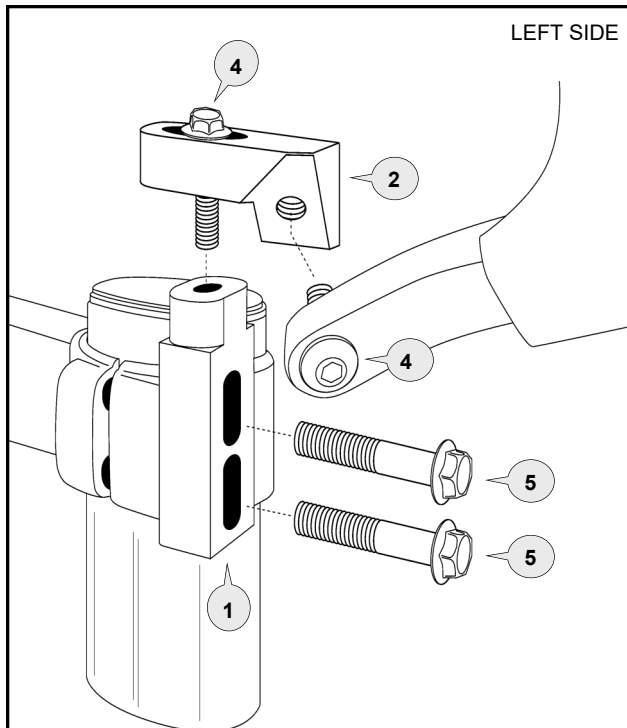

www.barkbusters.net

# FITTING INSTRUCTIONS for... Triple Clamp Mount Kit



**NOTE:** Fits most bikes with front or side top triple clamp pinch bolts regardless of handlebar size or type.

### Fitting Instructions

**Important:** Use a mild thread locking compound on all bolts.

Remove the original, top triple clamp pinch bolts. Fit the upright post (1), with the long flange bolts (5), to the top triple clamp (2 or 3).

**Do not tighten at this stage.**

The upright post (1) can be adjusted up and down for height variation.

Fit the Barkbusters handguard as per instructions on the packaging. Now fit the connecting arm between the Barkbusters alloy bar and the upright post (1) with the bolts supplied. (See diagram.)  
Diagram shows left side connecting arm with undercut towards the front.

Position all parts so they align with each other, and then tighten all bolts.

**The flange bolt (4) that holds the connecting arm to the upright post should be tightened last.**

**Note:** If this triple clamp mounting is fitted to a Honda XR 250/400/600 you will need to purchase 4 x 65mm long bolts to use in place of the 4 x 60mm bolts supplied. This is to ensure you have a minimum of 12mm thread engagement.



Phone: +61 (0)2 4271 8244  
Email: info@barkbusters.net

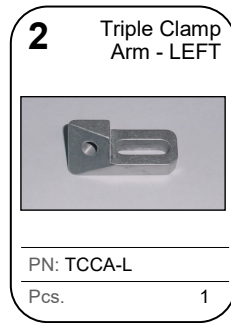
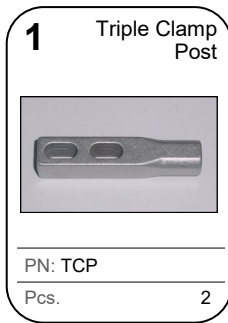

**CAUTION:**

Installation of the handguard is safety-relevant work and can be complicated. We recommend the installation be performed by a motorcycle service technician. Rideworx accepts no liability for damages caused by improper mounting. All screws, bolts and nuts, including all replacement hardware provided by Rideworx, should be tightened to the torque specified in the table. After the first 50km of riding check all screws, bolts and nuts are tightened to the correct torque. We recommend a medium strength liquid thread lock product on all fasteners.

**WARNING:**

It is important there is a working clearance (approx 3mm) between the throttle grip end and the handguard to ensure a free closing throttle. Check operation of all handlebar controls, specifically the throttle, front brake, kill switch and clutch to ensure they are operating correctly and are in accordance with the OEM specifications. Do not ride the motorcycle if any controls are not operating correctly. Check periodically that all bolts are tight.

Recommended Torque Settings	
M6	10 Nm (7.4 lbf ft)
M8	20 Nm (14.8 lbf ft)



Phone: +61 (0)2 4271 8244  
Email: [info@barkbusters.net](mailto:info@barkbusters.net)  
Web: [www.barkbusters.net](http://www.barkbusters.net)



**Disclaimer:**

A failure to follow these fitting instructions could cause serious injury, death or property damage. These handguards are intended solely for use with motorcycles/ATV/snowmobiles/scooters that have not been modified. They are not designed to prevent injury or death while riding or in an accident or crash. The user must ensure that all controls are free of the handguards every time that they ride. By installing and/or using this product you acknowledge that you accept these terms and have followed the fitting instructions.